

LPAH[®]

Aseptic washing valve for agitated tank



Presentation

The LPAH aseptic washing valve has been designed to provide enhanced cleaning of the tank during CIP cycles: it reaches the “blind spots” generated by components such as agitators and their shafts, anchors and scrapers.

Each LPAH valve is unique: SERVINOX studies the impact zones according to the characteristics of the tank and its components, for optimum washing efficiency and reduced cycle time. Mounted in the tank shell, its flush design means that it does not interfere with or damage the wall scrapers.

Key features

- Efficiency: Enhanced tank cleaning with the customised design of the spray grid, of which the number, size and orientation of the holes are calculated according to the positioning of the valve and the areas to be impacted inside the tank
- Profitability: Reduced CIP cycle costs
- Productivity: Increased plant availability with reduced CIP times
- Environment: Saves water and detergent
- Autonomy: In the event of a power cut, an assistance spring keeps it closed (double-acting valve control in normal operation)
- Reduced footprint
- Modularity: Body interchangeability with LPA-A & LRA valves

Applications

- Products requiring aseptic design
- For enhanced sanitation of agitated process tanks with scraping blades or proximity scrapers

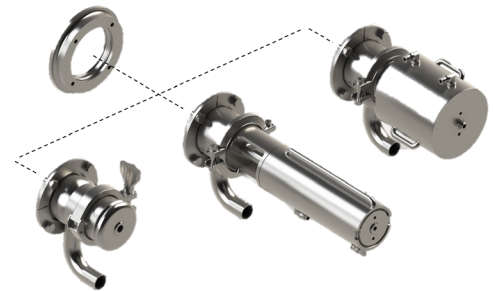

Technical features

Sizes: DN 25

Inlet fitting: Welding

SERVINOX

Connection to the tank: Flush welding flange

Operating pressure in tank: From -1 to +6 bar (if double-acting actuator)

Sealing: Up to 3 bar in the tank in the absence of air in the cylinder

Operating temperature: From +1°C to +120°C

Washing flowrate: 7 m³/h at 1.3 bar

CIP liquid pressure on closed valve: 6 bar (cylinder control air 6 bar)

Materials

- Parts in contact with the product: Stainless steel 1.4404 (316L)
- Other metallic parts: Stainless steel 1.4307 (304L)
- Cylinder body: Ground cylinder tube Stainless steel 1.4307 (304L)
- Seals in contact with the product: EPDM (Ethylene Propylene Diene Monomer) and PTFE (polytetrafluoroethane) for the membrane

Dimensions in mm

Standard version

Sizes	DN 25
ØA	139
B	247
C	53
D	110

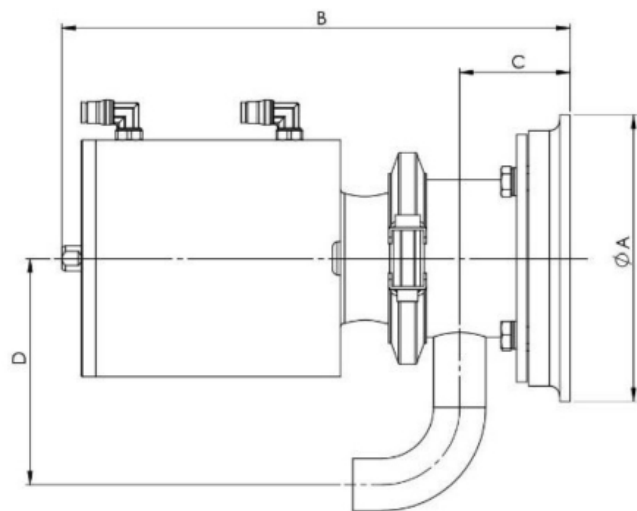

Options

- Control unit
- Position sensor
- Other inlet connection: clamp
- Specific surface finish
- Sealing: FKM (Fluorocarbon rubber, eq. Viton®) and Silicone (VMQ)

Warranty

12 months as from the date of dispatch (except for special conditions).

Conformity

- Elastomer seals compliant with FDA CFR 21.177.2600 and Regulation (EC) 1935/2004
- Option: Membranes compliant with USP Class VI

Non-contractual document and visuals, subject to change without notice.

Only the commercial offer and the technical manual supplied with the equipment may be used for technical and legal purposes.